

Spare parts
Ersatzteile
Pièces détachées
Reservdelar

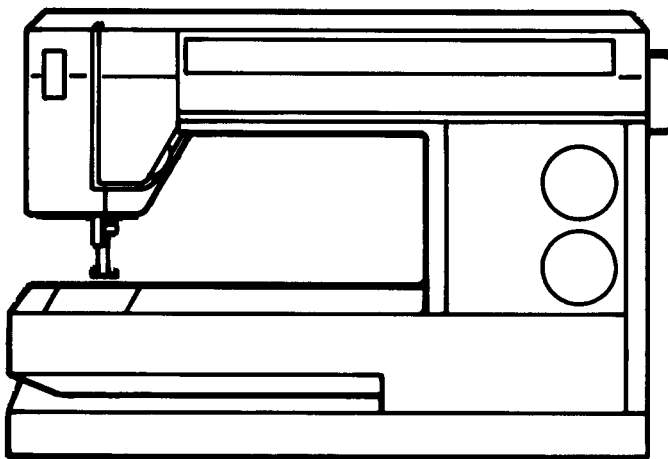

205

215

225

Part no	Description	Square	Part no	Description	Square
411 72 10-01	Washer	B	412 30 68-01	Bobbin case compl.	C
411 75 00-07	Needle bar compl.	E	412 30 71-01	Thread tension spring	C
411 75 02-01	Needle clamp	E	412 30 72-01	Hook cover compl. =	C
411 75 03-01	Stop needle clamp	E	replaced by	412 37 07-01	C
411 75 04-01	Thread guide	E	412 30 74-01	Damper	C
411 75 05-01	Screw needle clamp	E	412 30 77-02	Hook cover window old	C
411 82 62-07	Lamp holder stand.	E	412 30 78-45	Plastic bobbins (10-pac)	C,J
411 82 62-08	Lamp holder USA-Can	E	412 30 79-01	Eccentric feed	C
411 96 67-02	Screw	A	412 30 82-01	Sewing head compl.	E
411 96 68-02	Screw	C	412 30 83-01	Frame, sewing head	E
411 96 68-10	Screw	A	412 30 91-03	Regulating dial	E
411 96 68-12	Screw	A	412 30 96-02	Presser bar guide	E
411 98 14-01	Washer	B	412 30 97-01	Presser bar lifter	E
412 00 13-01	Washer	C	412 31 04-01	Guide compl.	B
412 01 48-02	Light bulb 100-120 V	E	412 31 06-01	Spring	B
412 02 41-01	Spring	E	412 31 07-01	Spring	B
412 02 69-02	Light bulb 220-250 V	E	412 31 17-01	Accessory box	J
412 05 60-01	Screw M5*14	A	412 31 20-01	Extension table	J
412 05 60-04	Screw M3*6	B	412 31 23-01	Isulation (male)	A
412 05 60-06	Screw M4*12	A,C,E,F	412 31 24-01	Isulation (female)	A
412 05 60-07	Screw M4*16	G	412 31 25-01	Nut	A
412 05 60-09	Screw M4*30	D	412 31 33-02	Plastic bag with access.	J
412 05 60-11	Screw M3*5	C	412 31 34-01	Soft-cover	J
412 15 23-02	Cross head compl.	E	412 31 41-01	Foot control compl.	H
412 15 78-01	Cord device, stand.	H	412 31 44-01	Cable Stand.	H
412 15 79-01	Cord device, USA, Can.	H	412 31 44-02	Cable USA, Can.	H
412 15 80-02	Cord device, England	H	412 31 48-01	Spring	B
412 15 81-01	Cord device, Australia	H	412 31 50-01	Stud	D
412 15 98-01	Spring	H	412 31 52-01	Thread knife	C
412 18 45-01	Foot	H	412 31 54-02	Base plate	A
412 21 14-04	Screw M3*10	E	412 31 60-41	Shaft sewing frame	E
412 27 41-01	Damper	E	412 31 65-45	PC-board 220-240 V	A
412 28 19-02	Screw	B,E	412 31 65-46	PC-board 100-120 V	A
412 28 43-01	Feed dog	B	412 31 69-01	Spring	D
412 28 48-01	Spring	B	412 31 79-01	Clutch	F
412 28 54-01	Presser bar	E	412 31 81-01	Clamp, lower shaft	C
412 28 61-01	Lever	D	412 31 83-01	Spring	B
412 28 63-01	Draw bar, feed mech.	B	412 31 84-01	Bushing, feed dog	B
412 28 66-01	Eccentric	D	412 31 85-01	Nut	B
412 28 64-01	Draw bar	E	412 31 89-01	Control unit	H
412 28 71-01	Shaft, cam set	D	412 31 97-01	Belt stretcher	A
412 28 72-01	Shaft	D	412 32 03-01	Screw	D
412 28 73-80	Lever compl.	D	412 32 13-01	Washer	B
412 28 75-01	Base plate	A	412 32 27-01	Bobbin winding	A
412 28 77-01	Attachment	A	412 32 31-01	Lever, slide	D
412 28 79-01	Screw	C	412 32 32-01	Spring	D
412 28 81-01	Throat plate	C	412 32 35-01	Reel pin	A
412 28 82-01	Worm wheel	D	412 32 38-02	Hinge	A
412 29 34-01	Motor compl.220-240 V	A	412 32 39-01	Cover	A
412 29 34-02	Motor compl.100-120 V	A	412 32 40-01	Window, cover HVA	A
412 29 38-01	Worm gear	C	412 32 40-02	Window, cover Viking	A
412 29 49-01	Holder	E	412 32 40-03	Window, cover LUX	A
412 29 51-01	Cam set	D	412 32 42-03	Front cover	A
412 29 71-01	Thread knife	A	412 32 43-01	Thread reel pin	J
412 29 73-01	Thread guide	A	412 32 44-01	Front cover HVA S2/25 =	A
412 29 74-01	Curve	D	Replaced by	412 36 64-01	A
412 29 75-01	Curve	D	412 32 44-02	Front cover Viking S2/25=	A
412 29 83-01	Pattern mech. S/2 25, 225	D	Replaced by	412 36 64-02	A
412 29 84-01	Slide	D	412 32 44-03	Front cover HVA S2/15 =	A
412 29 86-01	Planet wheel	D	Replaced by	412 36 64-03	A
412 29 87-01	Lifting arm	D	412 32 44-04	Front cover Viking S2/15=	A
412 29 88-01	Spring	D	Replaced by	412 36 64-04	A
412 29 89-01	Curve	D	412 32 45-01	Thread tension device	G
412 29 90-01	Hub, dial	D	412 32 47-01	Lever thread tension	G
412 29 93-01	Spring	D	412 32 49-01	Screw thread tension	G
412 29 94-01	Guide index	D	412 32 50-01	Spring holder	G
412 29 95-01	Spring	D	412 32 51-01	Control thread tension	G
412 30 06-01	Driver	F	412 32 53-01	Feed adj link	B
412 30 07-01	Spring	F	412 32 55-01	Eccentric	D
412 30 08-01	Pulley	F	412 32 60-01	Thread knife	A
412 30 09-01	Hand wheel	F	412 32 70-01	Knob, stitch length	D
412 30 16-01	Link	G	412 32 74-01	Knob, stitch selector	D
412 30 21-01	Locking washer	G	412 32 75-01	Sleeve, lamp	J
412 30 24-01	Crank arm	G	412 32 81-02	Dial zig zag	D
412 30 26-01	Cog belt	F	412 32 84-01	Clamp	C,F
412 30 27-01	Cog belt old 7 mm	F	412 32 96-01	Thread guide	A
412 30 30-01	Guide arm	E	412 33 67-01	Washer	D
412 30 42-01	Panel stitches S2/25 =	A	412 33 68-01	Panel stitches S2/15 =	A
replaced by	412 36 65-01	A	Replaced by	412 36 65-02	A
412 30 43-02	Panel stitch length	A	412 33 69-01	Eccentric balance	D
412 30 43-03	Panel stitch length 205	A	412 34 42-01	Hard cover	J
412 30 46-01	Back cover	A	412 34 60-01	Stop ring	C
412 30 47-01	Handle	A	412 35 26-01	Washer	C
412 30 48-01	Name plate HVA	A	412 35 31-01	Thread tension set	G
412 30 48-04	Name plate LUX	A	412 35 33-01	Driving wheel compl.	A
412 30 50-01	Foot	A	412 35 39-01	Pattern mech. S/2 15, 215	D
412 30 58-01	Dial	D	412 35 39-04	Pattern mechanism 205	D
412 30 61-01	Hook	C	412 35 42-01	Pulley	C
412 30 65-01	Magnet	C	412 36 14-01	Opener, throat plate	J
412 30 66-01	Shuttle shaft	C	412 36 16-01	Hook cover window	C

Part no	Description	Square	
412 36 55-01	Bobbin case stop		C
412 36 64-01	Front cover HVA 225		A
412 36 64-02	Front cover Viking 225		A
412 36 64-03	Front cover HVA 215		A
412 36 64-04	Front cover Viking 215		A
412 36 64-05	Front cover HVA 205		A
412 36 64-06	Front cover Viking 205		A
412 36 64-07	Front cover LUX		A
412 36 65-01	Panel stitches 225		A
412 36 65-02	Panel stitches 215		A
412 36 65-03	Panel stitches 205		A
412 36 65-04	Panel stitches LUX		A
412 36 67-01	Guide HVA 225		A
412 36 67-02	Guide LUX		A
412 36 78-01	Spring		G
412 36 80-01	Locking washer		B
412 36 82-01	Lower shaft compl.		C
412 36 83-01	Arm shaft compl.		F
412 36 84-01	Cog belt 10 mm		F
412 36 86-01	Hook cover compl.		C
412 36 87-01	Pin		F
412 37 07-01	Hook cover reconstruction kit compl. for old machines		C
412 37 11-01	Thread real disc 20 mm		A
412 37 11-02	Thread real disc 40 mm		A
412 37 23-01	Index band, red		A
412 38 16-01	Feed unit compl		B
412 38 92-01	Thread take up		E
412 39 47-01	Washer		C
412 40 29-01	Lever feed lifte		B
721 11 66-10	Pin		D
721 41 87-70	Pin		C,F
721 42 10-10	Pin		C
723 12 19-01	Screw M3*5		E
725 62 91-01	Screw M4*12		E
728 32 18-01	Screw M3*4		C
728 52 18-05	Screw		E
728 52 82-00	Screw M4*3		C
728 52 85-05	Screw M4*6		E
728 52 87-05	Screw M4*8		C,D
728 52 91-01	Screw M4*12		B,D
728 53 20-05	Screw M5*5		F
728 53 23-05	Screw M5*8		D
728 58 01-05	Screw M5*4		C
728 73 20-01	Screw		F
728 73 64-05	Screw 6*10 mm		A
728 82 83-05	Screw M4*4		C,F
731 23 10-01	Nut M3		D
731 23 12-01	Nut M4		D
735 31 08-20	C-washer		C
735 31 10-20	C-washer		D,F
735 58 10-10	Washer		F
735 58 52-01	Locking washer		D
735 61 24-40	Compression ring 3mm		B,G
735 61 36-40	Compression ring 4mm		D,E
735 61 46-40	Compression ring 5mm		D
735 61 53-40	Compression ring 6mm		E

ACCESSORIES

401 53 99-01	Buttonhole knife		J
401 55 55-01	Brush		J
411 17 32-01	Button red		J
412 01 76-01	Hemmer 10 mm		J
412 29 48-01	Presser foot "A"		J
412 31 40-01	Blind stitch foot "D"		J
412 32 00-01	Presser foot "B"		J
412 32 25-01	Buttonhole foot "C"		J
412 32 26-01	Zipper foot "E"		J
412 32 83-01	Edging foot "J"		J
412 34 66-45	Glide plates		J
412 34 71-01	Holder		J
412 34 73-01	Gathering foot		J
412 38 15-01	Screw driver medium		J

OPERATING MANUALS

412 36 74-05	Operating man. Swe/Fin		J
412 36 74-15	Operating man. Dan/Nor		J
412 36 74-25	Operating man. Fra/Dutch		J
412 36 74-35	Operating man. Ger/Ita		J
412 36 74-45	Operating man. Eng/Spa		J
412 36 93-25	Operating man. LUX		J

A

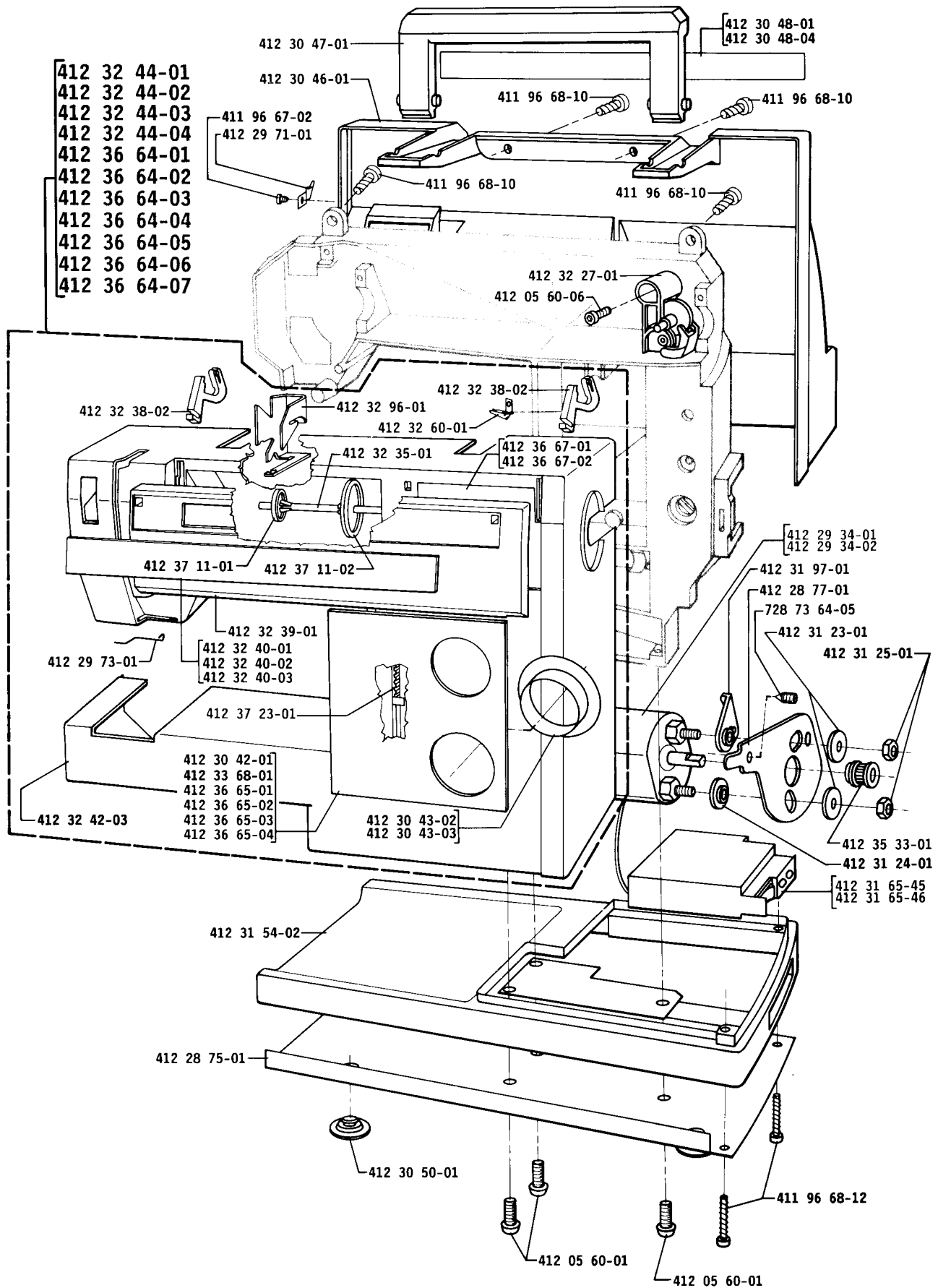

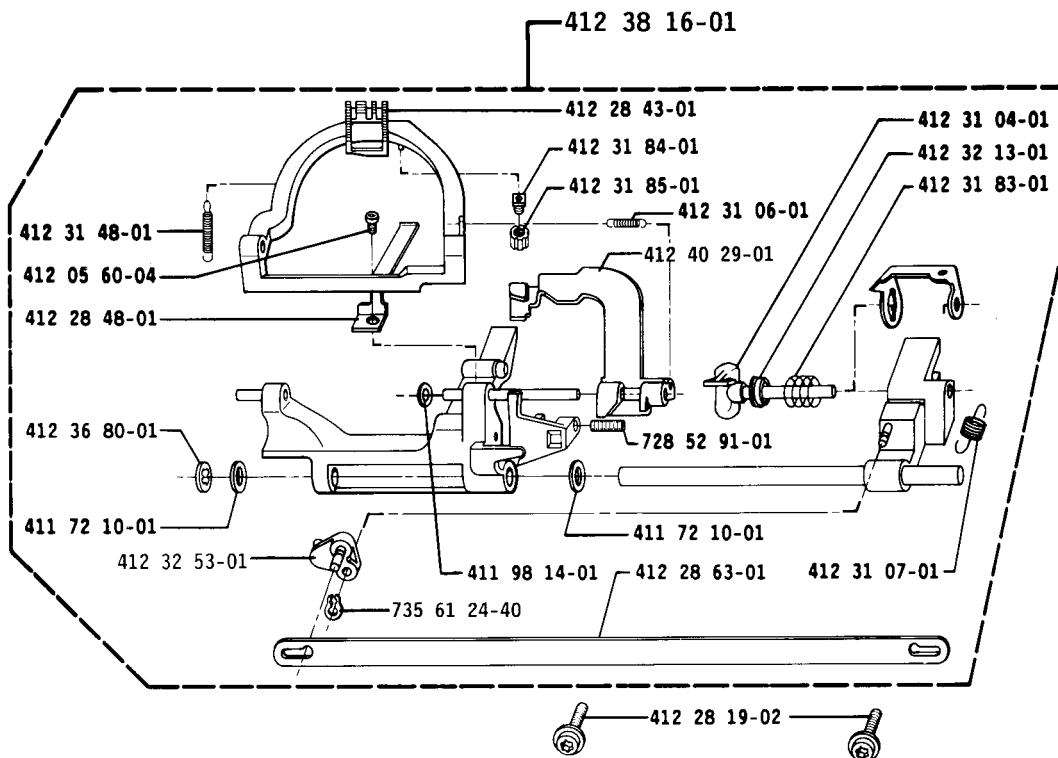
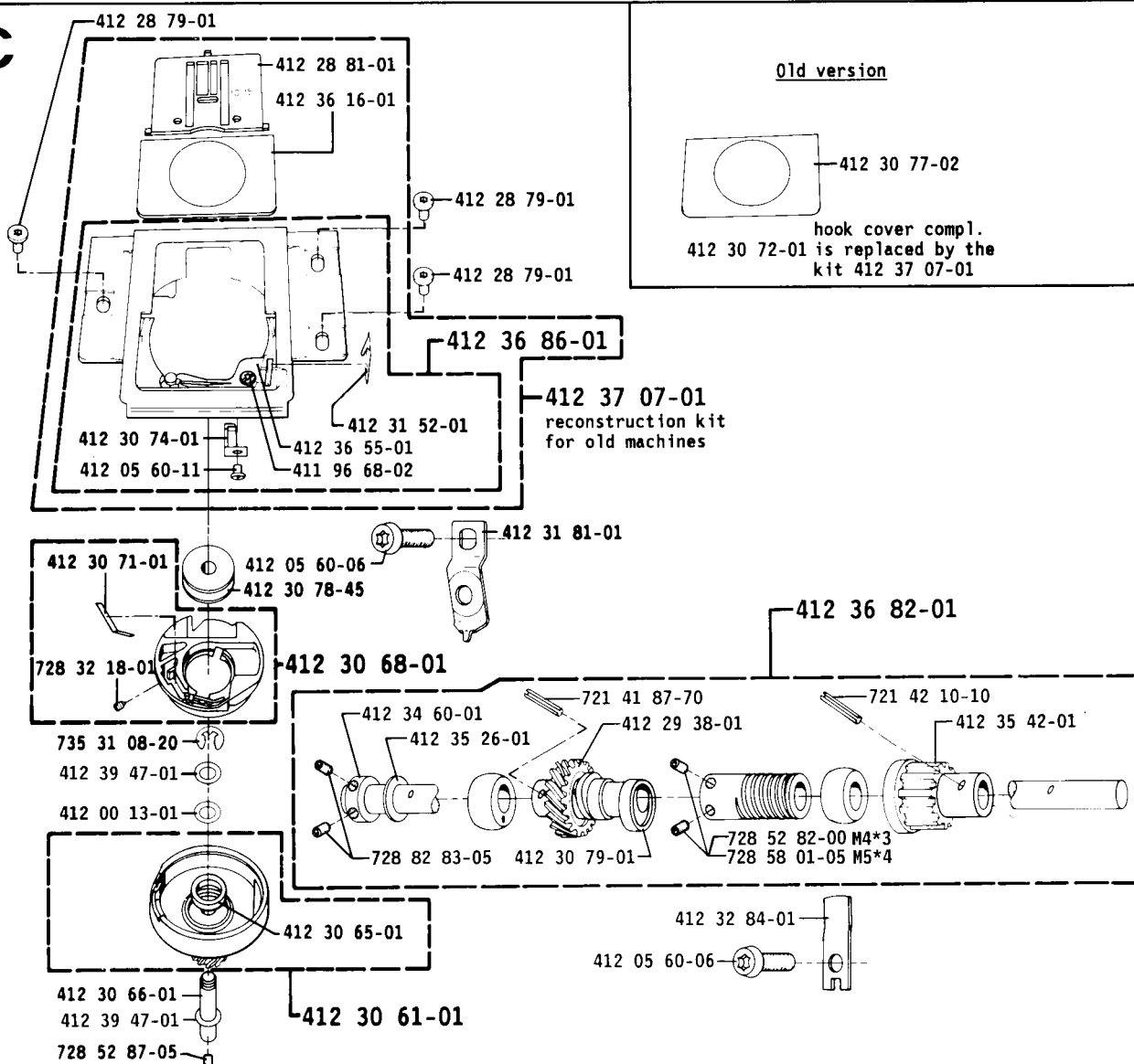
B**C**

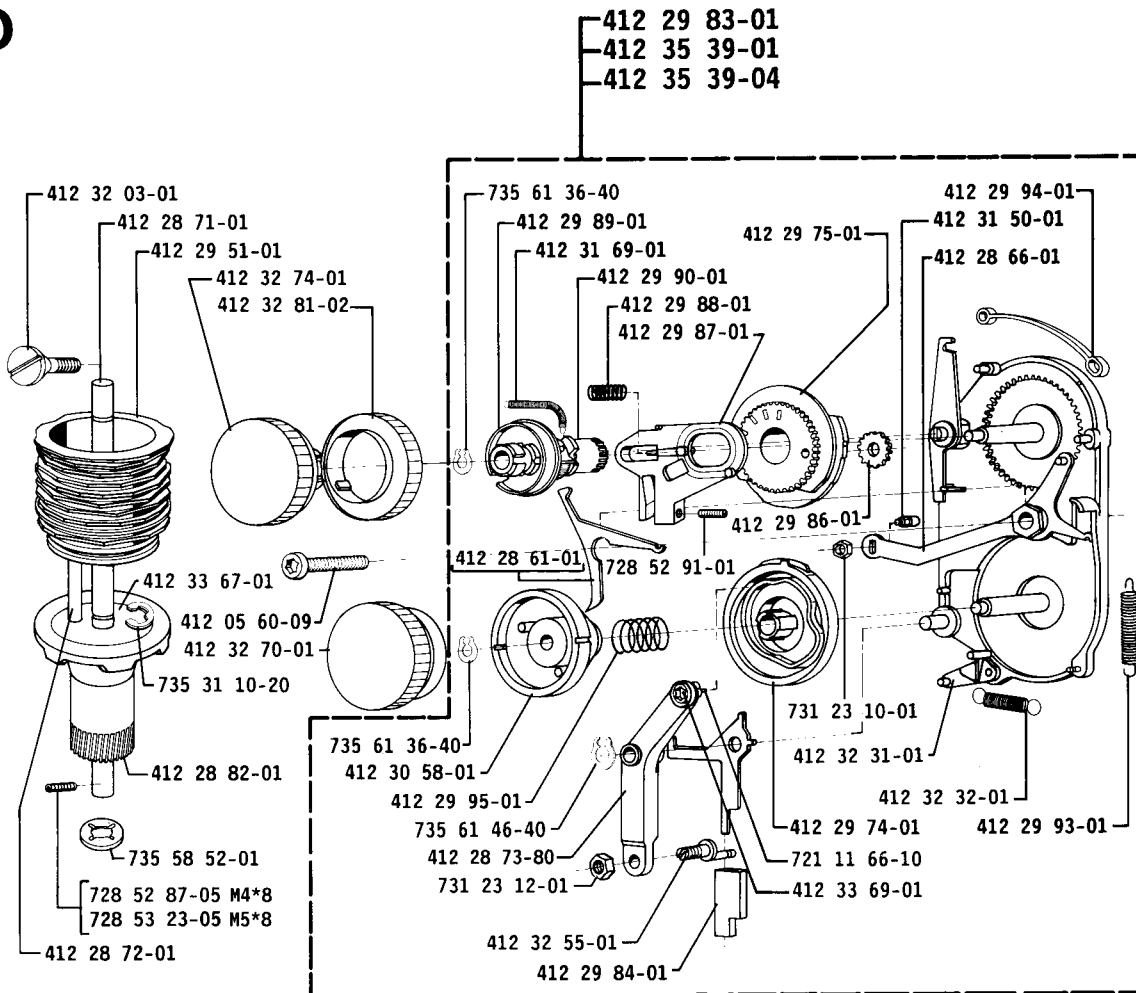
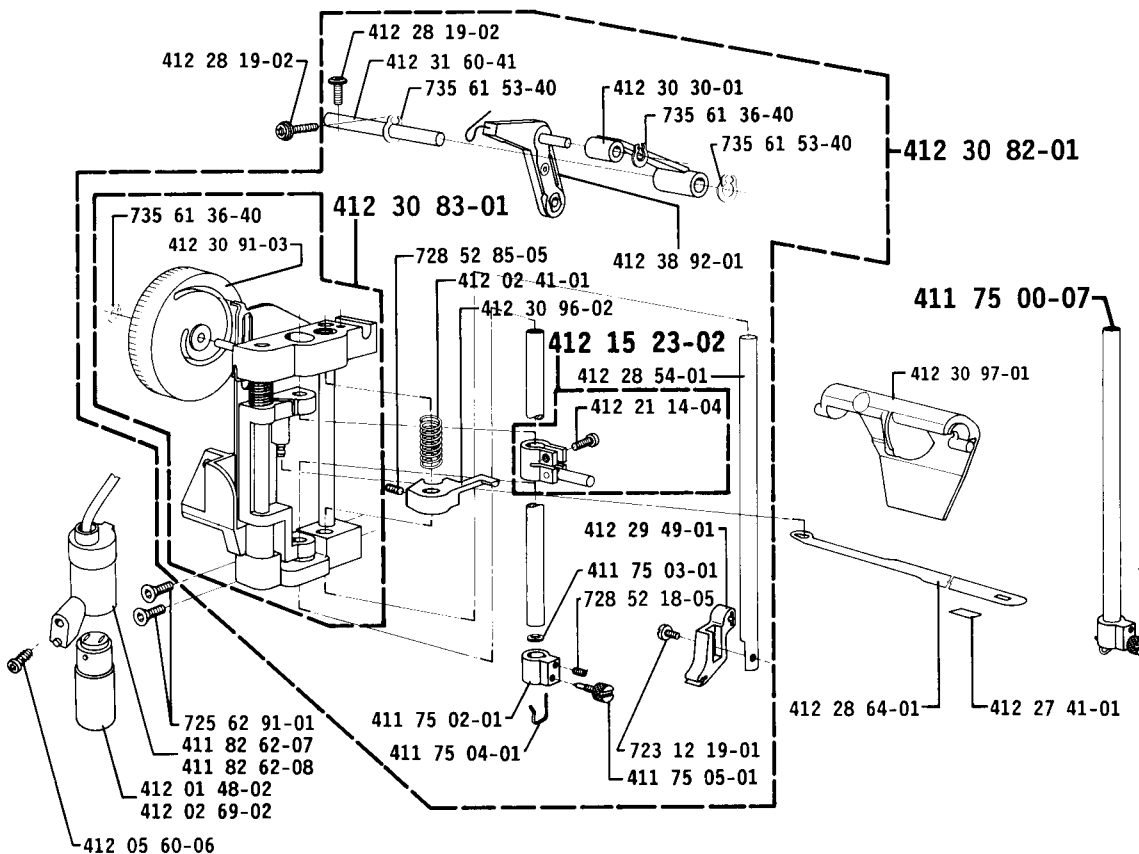
D**E**

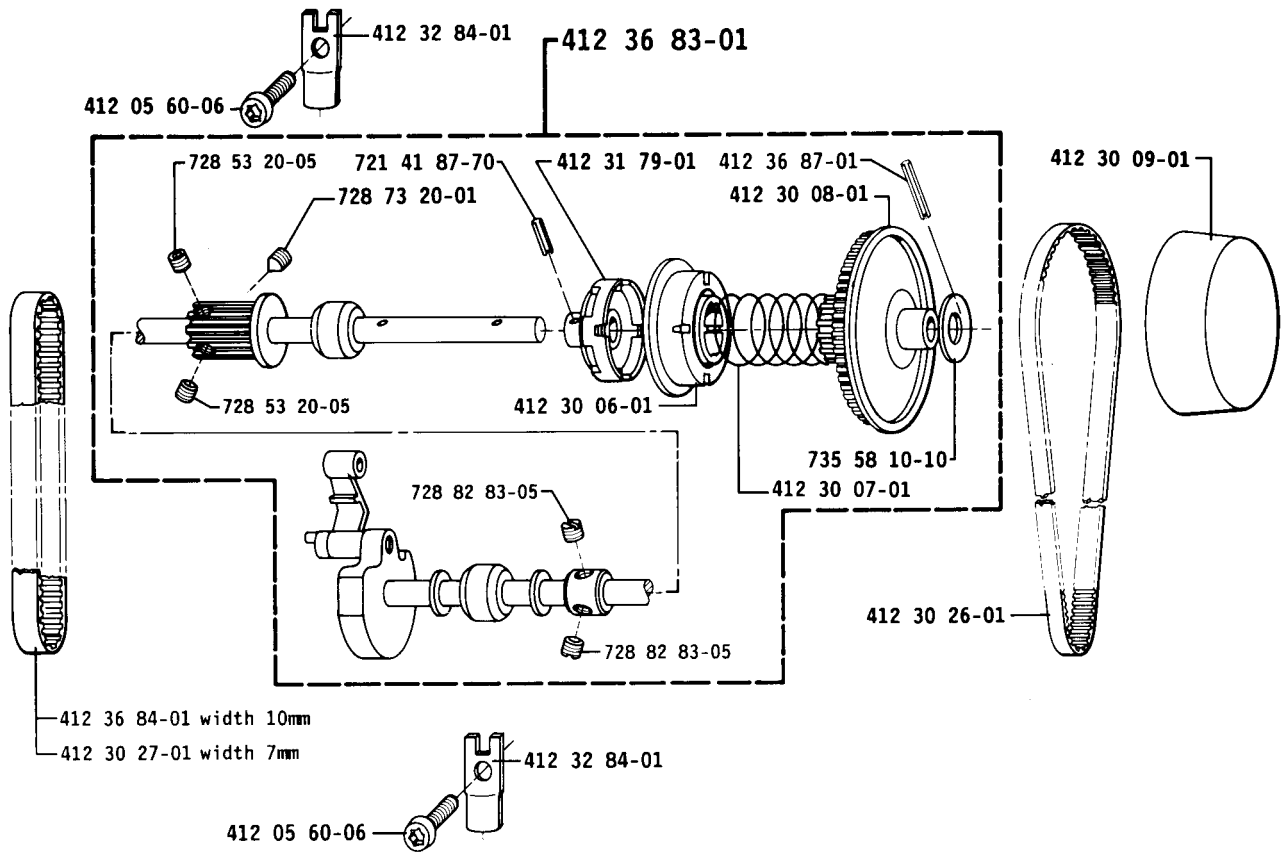
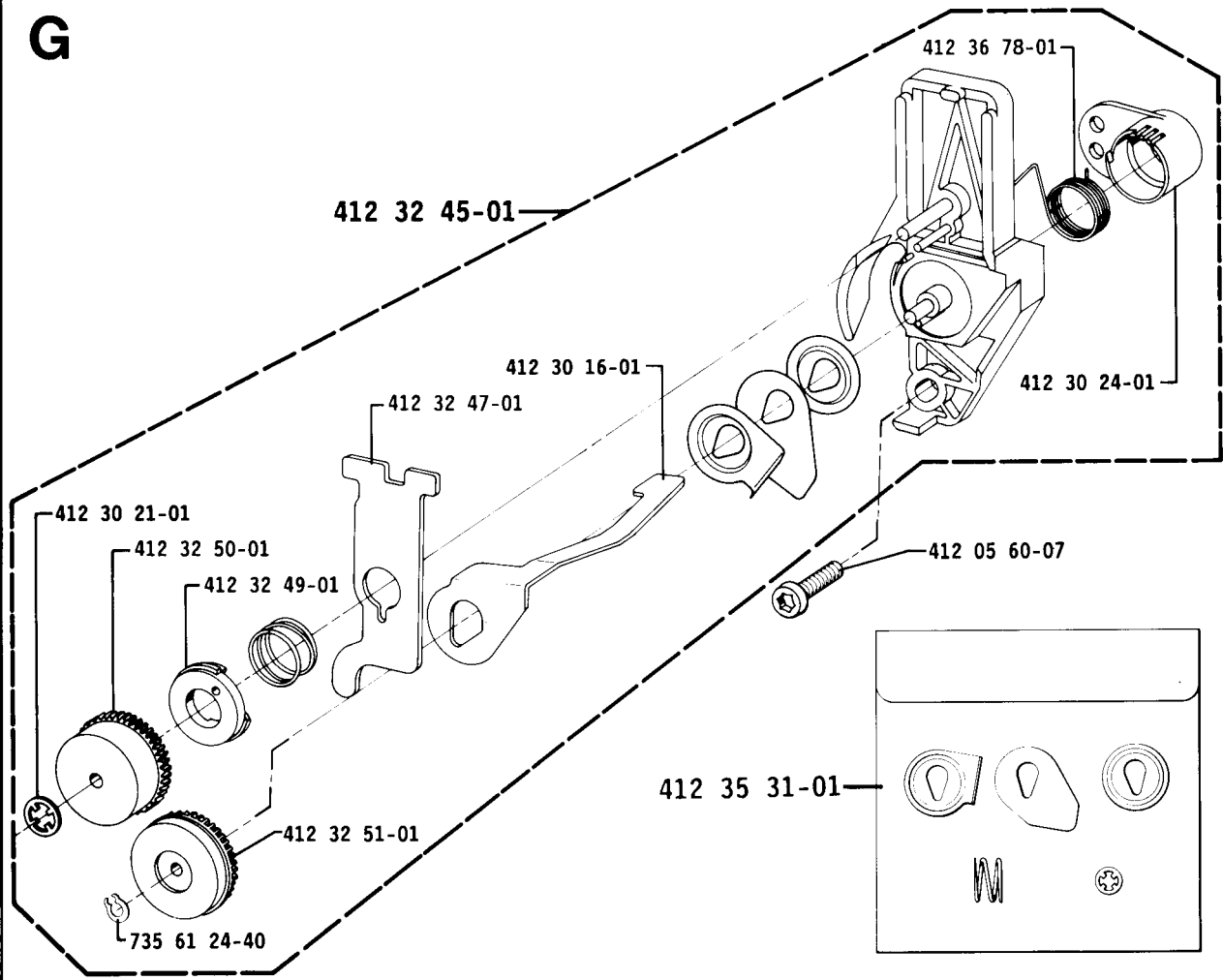
F**G**

H

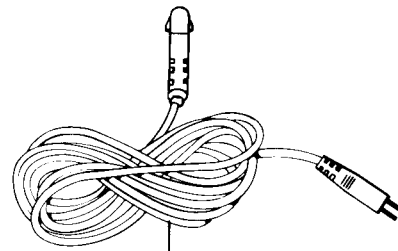
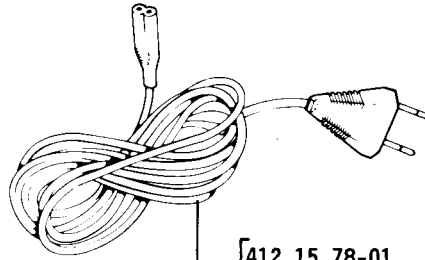
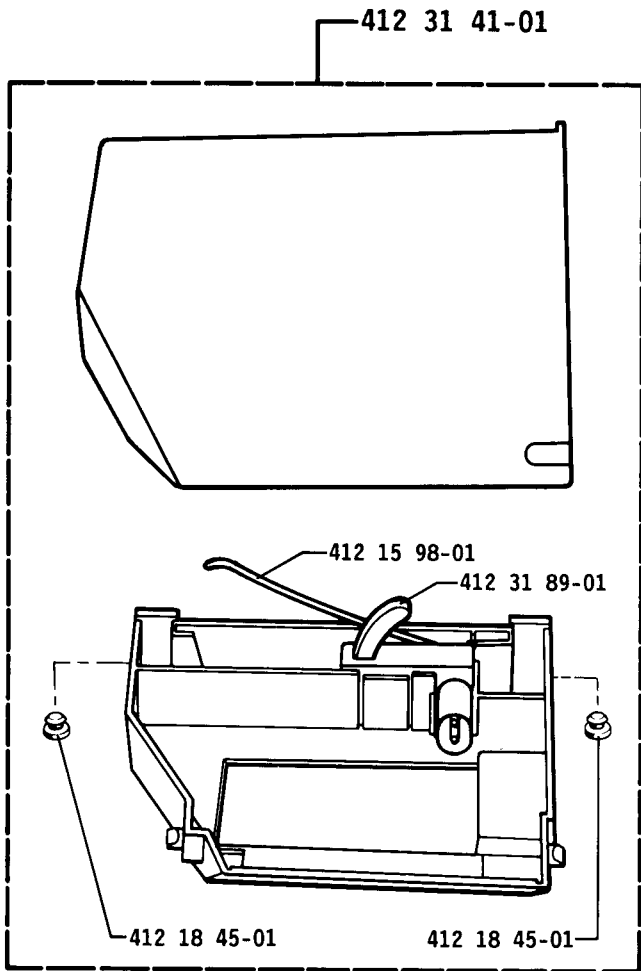

J

